

## Second Circular



<http://basalt.geology.utoronto.ca/facultycaron/Walcott2009.htm>



<b>Welcome</b> .....	3
<b>Meeting Format and Location</b> .....	3
<b>Deadlines</b> .....	5
<b>Field Trips</b> .....	5
<b>1. Logistics and preliminary schedule:</b> .....	8
<b>2. Costs:</b> .....	11
<b>3. Clothing and other items:</b> .....	11
<b>4. Safety:</b> .....	11
<b>5. Waiver, health related issues and travel and medical insurance:</b> .....	12
<b>6. Weather and Cancellations:</b> .....	12
<b>7. Fossil protection:</b> .....	12
<b>Registration</b> .....	13
<b>Conference Package</b> .....	14
<b>Travel Grants for Students-Volunteers</b> .....	14
<b>Call for Abstracts</b> .....	15
<b>Special Volume</b> .....	16
<b>Travel Information</b> .....	16
<b>Directions to “The Banff Centre”</b> .....	16
<b>Banff Centre Campus</b> .....	19
<b>Travel Insurance</b> .....	20
<b>Contact Info</b> .....	20
<b>International Scientific and Organizing Committee</b> .....	20
<b>Sponsors</b> .....	21



## Welcome

It is with great pleasure that we present the Second Circular for the *International Conference on the Cambrian Explosion* which will be held in Banff, Alberta from August 3rd to 8th, 2009. This special meeting commemorating the **100th anniversary of the discovery of the Burgess Shale by Charles Doolittle Walcott** will be an opportunity for delegates from around the world to share up-to-date knowledge on the important physical, chemical, and biological changes marking the Precambrian-Cambrian transition. Following release of the First Circular, we received an overwhelming response from both academics and members of the general public and we would like to thank everyone who returned a pre-registration form over the last 18 months. At most recent count, we have received close to 150 replies representing delegates from 15 different countries.

## Meeting Format and Location

The main conference will be convened at the Banff Centre from **August 4<sup>th</sup> to August 6<sup>th</sup>**. The resort town of Banff, about 125 km west of Calgary, Alberta, is one of the most scenic locations in the Canadian Rocky Mountain National Parks and lies only 85 km away from the discovery site of the Burgess Shale (near Field, British Columbia). We will organize **field trips** to two Burgess Shale localities on Monday August 3<sup>rd</sup>, Friday August 7<sup>th</sup> and Saturday August 8<sup>th</sup>. Our **icebreaker** and registration will be held at the Whyte Museum of the Rockies in Banff on the evening of Monday August 3<sup>rd</sup> following the Monday field trips. At the Whyte Museum, delegates will be able to view a special temporary **exhibit** on C. D. Walcott and the discovery of the Burgess Shale during the icebreaker and over the remainder of the meeting. A “**centennial dinner**” will be organized at the Banff Centre on Thursday August 6<sup>th</sup>.

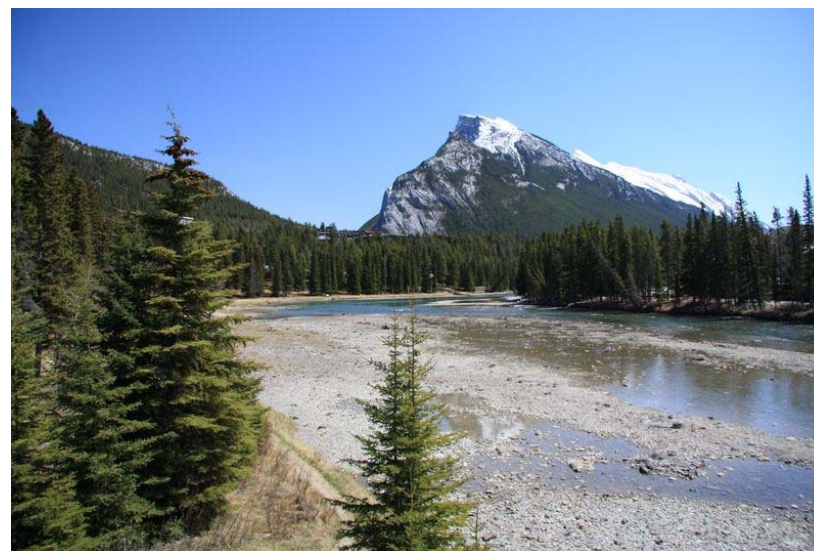

The Banff Centre – seen just above and left of middle of image. *Photo JB Caron*



We will have **three days of formal presentations** (oral and poster formats) starting on Tuesday August 4<sup>th</sup> and finishing on Thursday August 6<sup>th</sup>. Each talk will be 15 to 20 minutes in length. There will be no parallel sessions. Please note that the official language of the conference is English.

Talks and posters will cover the following topics:

1. **C. D. Walcott: the discovery and study of the Burgess Shale**
2. **Precambrian life and environments: prelude to the Cambrian Explosion**
3. **Global environmental changes during the Precambrian - Cambrian transition, including paleotectonics and geochemistry of Precambrian and Cambrian seas**
4. **Taphonomy and sedimentology of Burgess Shale-type deposits**
5. **Paleobiology and paleoecology of Cambrian animals**
6. **Paleocommunity reconstructions of Cambrian biotas**
7. **The origin of body plans from developmental and molecular biological perspectives**



**Keynote speakers:** We have invited eight keynote speakers to give a series of 45-50 minute talks during the conference on different complementary themes. These talks will be free and open to conference delegates and the general public:

**Derek Briggs** (Yale University)  
**Nick Butterfield** (University of Cambridge)  
**Desmond Collins** (Royal Ontario Museum)  
**Simon Conway Morris** (University of Cambridge)  
**Douglas Erwin** (Smithsonian Institution)  
**Chen Junyuan** (Chinese Academy of Sciences)  
**Nigel Hughes** (University of California)  
**Guy Narbonne** (Queen's University)



The resort town of Banff, Alberta. *Photo JB Caron*



## Deadlines

**January 31<sup>st</sup>** Early bird registration

**April 1<sup>st</sup>** Final deadline for registration and abstract submission

PLEASE COMPLETE AND RETURN THE REGISTRATION FORM BEFORE THE DEADLINES! (See instructions on the registration form itself)

## Field Trips

A major highlight of this meeting will be an opportunity for conference delegates to visit the main Burgess Shale locality (Walcott Quarry), and sites on Mount Stephen, including the famous Trilobite (*Ogygopsis*) Beds. Both are UNESCO protected World Heritage sites and lie within the boundaries of Yoho National Park. We have had to add an extra day of field trips to the Walcott Quarry on Saturday Aug 8<sup>th</sup> to accommodate a larger number of delegates than originally anticipated.

**Walcott Quarry (Field Trip 1):** Starting Elevation: 1500 m; Elevation gain: 780 m; Distance: 20 km in total. Duration about 9-10 hours. Hike of moderate difficulty - long, but not steep for the most part. We will start the hike in the scenic Yoho Valley near Takkakaw Falls (the highest in Canada), a few km north of the town of Field. Stops or sceneries of interest will include: Takkakaw Falls, Yoho Lake, Emerald Lake, the ROM field camp, Walcott's Quarry, and Burgess Pass. The hike ends at the Yoho National Park Visitor Centre in Field.

Right, Takkakaw Falls. *Photo JB Caron.*





Top left, Emerald Lake. Bottom left, Walcott Quarry with Wapta Mountain in the background. Right, *Odaraia alata* from the Walcott Quarry. Photos JB Caron.



**Mount Stephen (Field Trip 2):** Starting Elevation: 1300 m; Elevation gain: around 600 m. Distance: 6 km round trip. Duration about 8 hours. Hike of moderate difficulty, short but steep. Stops of interest will include: Lower and Upper Trilobite Beds. The hike begins and ends at the Yoho National Park Visitor Centre in Field.



Left, Mount Stephen with location of the Trilobite Beds (circle). Right, Mount Stephen Trilobite Beds. *Photos JB Caron*



## 1. Logistics and preliminary schedule:

The Walcott Quarry and the Mount Stephen Trilobite Beds are close to the village of Field, British Columbia. Travel from Banff to Field will take approximately one hour and will be by chartered coach only. The trail to the Trilobite Beds can be accessed directly from Field, whereas the hike to the Walcott Quarry will start from Takkakaw Falls, about a 25 minute drive from Field. Field trips are planned for the following days (total number of delegates pre-registered shown in brackets). We cannot accept more than 50 delegates per site per day:

Monday August 3<sup>rd</sup>, Walcott Quarry (50-FULL) and Trilobite Beds (50-FULL)  
Friday August 7<sup>th</sup>, Walcott Quarry (50-FULL) and Trilobite Beds (50-FULL)  
Saturday August 8<sup>th</sup>, Walcott Quarry (29\*- 21 spaces available). (\*as of Dec 1-2008)

The Monday and Friday hikes are now full. We have added two extra hikes on Saturday August 8<sup>th</sup> to the Walcott Quarry only to accommodate delegates on our waiting list; more spots are available for these hikes. We could not accommodate all requests and some delegates will not be able to visit the Trilobite Beds - we apologize for this inconvenience.

**IMPORTANT all pre-registered delegates must confirm the field trips they wish to attend on the registration form. Please find your name (followed by number of registrants, including yourself, under that name) in the appropriate lists provided by e-mail on Dec 1<sup>st</sup>-2008. The trip assignments are based, to the best of our ability, on the choices you made during pre-registration. We do apologize if we could not accommodate your first choice. For those who were advised they were on a waiting list, we have now assigned you to a group as space permitted. Due to the complex logistics of the field trips we are unable to alter these placements for anything but the most exceptional circumstances. Thank you for your understanding and cooperation.**

Delegates registered for hikes will meet at the Banff Centre no later than 6.30 am on their selected day. Breakfast and lunch bags can be ordered from the Banff Centre in advance and will be made available to delegates prior to departure (OPTIONAL - see registration form). Return time to the Banff Centre will depend on your hike selection (Walcott Quarry or Trilobite Beds), the speed of your group, and weather conditions. Estimated return times are between 6:30 pm and 7:30 pm for delegates registered for the Trilobite Beds hike, and between 8:00 pm and 9.00 pm for those registered for the Walcott Quarry hike.

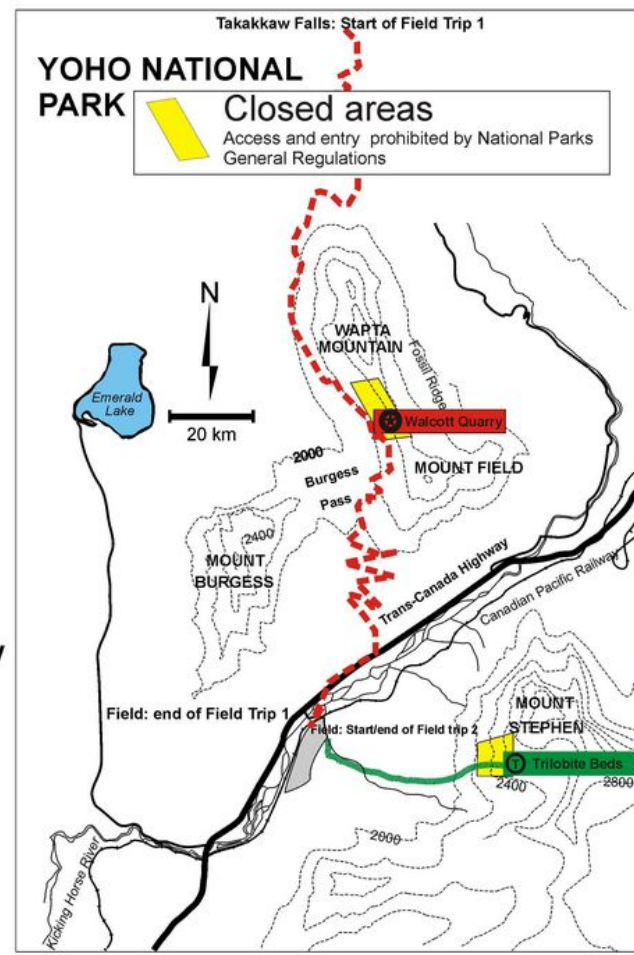
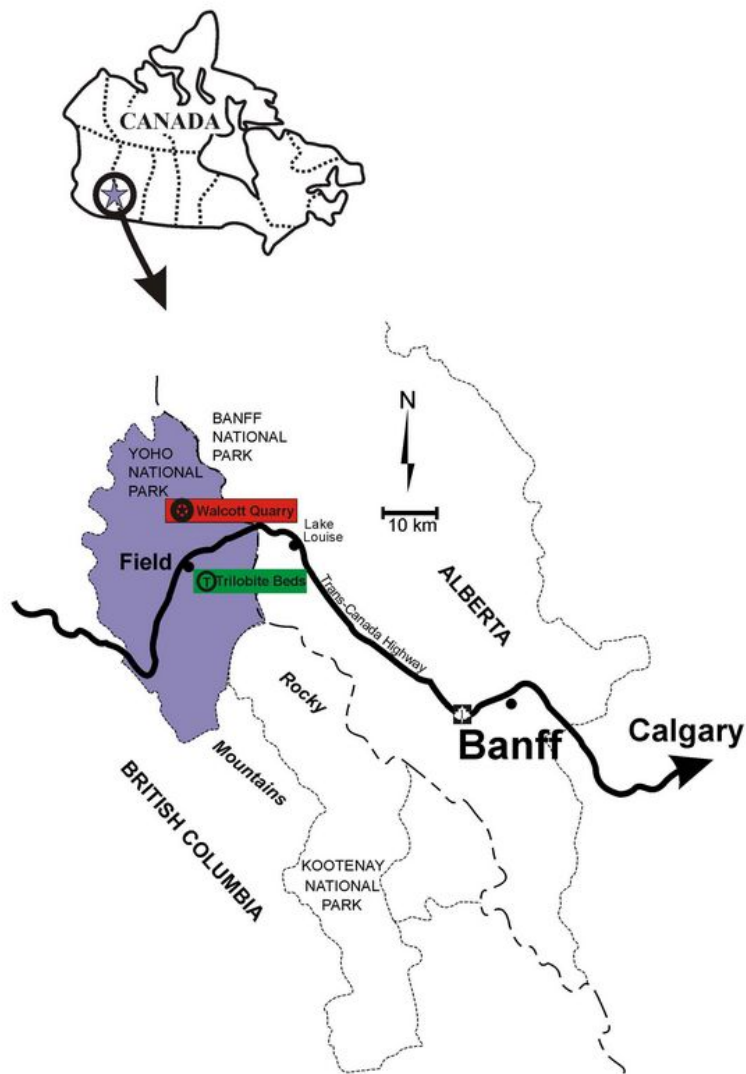



All delegates for a particular hike (up to 50 people) will start on the trail at about the same time, but for logistical and security reasons, only 25 people and 2 guides will be allowed to visit the Walcott Quarry or the Trilobite Beds at one time. We expect that delegates will hike at different speeds. Two groups, a slow and a fast group of equal numbers will be created closer to the main sites to avoid overcrowding. If time permits, and with the possible exception of the slowest groups for both hikes, most delegates will be able to visit the new Burgess Shale display at the Field Information Centre, and/or Emerald Lake after the hikes. There is a nice vista of the Walcott Quarry (especially in the evening) from across Emerald Lake, and delegates will be able to see the UNESCO World Heritage Plaque and a small outdoor display on the Burgess Shale.



Left, Emerald Lake interpretative panels on the Burgess Shale with World Heritage Plaque to the left. The Walcott Quarry is in the background (circle). Right, part of an outdoor exhibit at the Field Information Centre in Field. *Photos JB Caron*



**2. Costs:**

Each field trip package costs \$60 per delegate and includes:

- Return transportation from the Banff Centre to Field by chartered coach
- Visit to Emerald Lake (if time permits)
- Visit to new Burgess Shale exhibit at the Yoho National Park Visitor Centre in Field (if time permits)
- Field guidebook (one guidebook per delegate - covers both trips)
- Extra water bottles and some light snacks. We highly recommend bringing at least 2 liters of water as well as high carbohydrate snacks (chocolate bars, power bars, raisins etc...). **Meals are not included, but can be pre-ordered from the Banff Centre (see registration form).**

**3. Clothing and other items:**

Participants should bring clothes suitable for dry or rainy weather and cold or warm temperatures (see weather advisories below). Good hiking boots (running shoes not recommended), a hat, rain gear (poncho, rain suit or water-proof jacket), light weight, loose fitting long sleeved shirt and long pants (to protect against the sun and mosquitoes), and a light windbreaker or sweatshirt fleece are essential. Carrying some extra dry clothing is recommended. Mosquitoes are not common in this part of the Canadian Rockies but you might want to bring some mosquito repellent. Sunscreen and sunglasses with UV protection are also recommended.

**4. Safety:**

Safety is paramount. We want to minimize the potential for accidents wherever possible, and your awareness of the following safety concerns is important for your personal well-being, and for that of other field trip members. For safety reasons, the field trips will be monitored by Parks Canada staff and we will be in radio communication with the outside world at all times. An emergency first aid kit will also be carried on each field trip.

Nature of Hazard	Location of Hazard	Mitigation
Possible cold rain/wet snow	All outcrops	Bring appropriate wet-weather gear, hat, extra layers, etc.
Sprains or other ankle injuries	All outcrops	Wear high-topped and sturdy hiking boots
Rough, steep trail to outcrop with loose rocks	Upper part of trails. All outcrops	Avoid loosening stones on trail, warn those below
Heat related problems	All outcrops	Drink water with electrolytes, wear hat, use sunscreen
Wildlife encounter	All outcrops. Bear encounter are unlikely due to group size	Make loud noises, avoid areas with berries



**5. Waiver, health related issues and travel and medical insurance:**

All delegates registered for field trips must complete and sign a waiver prior to participation (this document can be downloaded on our website). This form must be completed and signed and presented in person before each field trip to the field trip leader (to be assigned at a latter date). **HEALTH:** These hikes can definitely be arduous for the untrained or ill-prepared. Because of potential mild altitude sickness, it is preferable to arrive in Banff a day or two in advance to acclimatize to the mountain environment. Each hike will be a full day long. **INSURANCE:** Please be sure that you have adequate Health/Accident/Emergency insurance for your time in the field. The organizers will not be responsible for your health coverage, highway ambulance service, hospital stays or any costs related to accident-emergency situations prior to, during, or after your stay in Canada for this meeting and field trips.

**6. Weather and Cancellations:**

Access to the sites is weather dependent. Please be advised that unpredictable weather conditions might result in last minute cancellations of some field trips. July and August are the hottest months of the year in Alberta-B.C. Daytime temperatures can reach 40°C or higher and dip below 10°C at night. Snow and violent thunderstorms are also common during this time of the year in the Canadian Rockies. Southern Alberta and Southern BC will probably be under Severe Fire Hazard conditions so do not use any open flames and refrain from smoking at all times. **NOTE:** these conditions may limit or **CANCEL** our field trips. Organizers are not responsible if hikes have to be cancelled because of poor weather conditions or for any other reasons beyond their control.

**7. Fossil protection:**

Absolutely no collecting of fossils will be permitted on the field trips – hammers are not allowed. It is unlawful to deface, remove, possess, or sell Burgess Shale fossils.





## Registration

Registration opens December 1<sup>st</sup> 2008. The number of registrations will be limited to 330 delegates, which corresponds to the size of our main auditorium at the Banff Centre. Registrations will be processed on a “first come - first serve” basis and preference will be given to delegates who have already pre-registered. New registrations, including those for field trips, will be accepted only if space permits.

### **Early bird registration ends on January 31<sup>st</sup>**

**Until January 31<sup>st</sup>**, the delegate rate is \$125 and the student delegate rate is \$50.

**From February 1<sup>st</sup> to April 1<sup>st</sup>**, the delegate rate is \$150 and the student delegate rate is \$75. All fees are in Canadian dollars (CAD).

Students fees are for Undergraduate and Graduate students only.

Please note the registration fees include an icebreaker party on Monday August 3rd at the Whyte Museum in Banff, as well as the abstract volume for the conference.

Guests (non-delegates) do not pay registration fees, but are welcome to participate at all social events organized during the Conference (including keynote lectures and icebreaker). If guests **ARE** attending the conference sessions, registration fees have to be paid.

**Final registration is April 1<sup>st</sup>. No refunds will be considered after April 15<sup>th</sup>.**

**In order to validate this registration, delegates must also book the Conference Package (see below) covering accommodation and meals at the Banff Centre for the core meeting dates. Your credit card information is necessary to register for the conference and to reserve your Conference Package at the Banff Centre.**

In addition, we highly recommend that those attending the field trips book their stay at the Banff Centre on Sunday August 2nd, Thursday August 6th, Friday August 7th, and Saturday August 8th, as well as taking the optional breakfast and lunch bags. Departure for the field trips will be from the Banff Centre at 6:30 am. Other accommodation options are available in Banff for these dates, but you will be responsible for booking these yourself.



## Conference Package

We have negotiated with the Banff Centre for a Conference Package which covers accommodation for 3 nights during the technical sessions (single or double rates, on August 3rd, 4th and 5th). This package also includes wireless internet access in bedrooms, meals on the 4th, 5th and 6th including 3 Marché Breakfasts, 3 Marché Lunches, 2 Marché Dinners (on the 4th and 5th), 6 Nutrition Breaks, all food & beverage service charges and taxes, delegate use of the Sally Borden Recreation Facility, and facility costs.

**This Conference Package is mandatory for all delegates (except local residents, see below) in order to validate registration. All quoted costs are in Canadian dollars (CAD).**

- Single rate = **\$910.00 for one or two people- see conditions below** (typically one king or queen size bed)
- Double rate = **\$592.00 per person** (with two queen size beds, or two double beds, or one king size bed that can also be converted to two twin beds)

If you are bringing your spouse/companion and they **ARE** attending the conference sessions, this person will be considered a delegate and will need to pay registration fees. If you are sharing a room with a delegate, please choose the Double rate, if not please choose the Single rate (there is no charge for a spouse/companion sharing a room with a single delegate).

You will be able to indicate the name of your chosen sharing person (if applicable) on the registration form. **\*Each sharing delegate (but not accompanying guests) must complete his or her own registration form\*.**

**Declining this package is only available as an option for local residents upon approval by the organizing committee.** A mandatory fee of **\$100** will be charged in addition to the registration fee if the Special Conference Package is declined to cover mandatory facility costs, equipment rentals and nutrition breaks. Meals can be purchased directly at the Banff Centre during the meeting at the following rates: Breakfast (\$16.50), Lunch (\$20.50), Dinner (\$37.50).

## Travel Grants for Students-Volunteers

Thanks to the generous support of the Paleontological Association, the Paleontological Society, and the Paleontology Division of the Geological Association of Canada, travel grants of **\$600.00 (CAD)** are available for the first 15 pre-registered students if their presentation (oral or poster) is accepted. There is no need to apply. Cheques will be mailed out to qualifying students before the meeting. Additional support may be available to student volunteers helping at the conference.



## Call for Abstracts

Delegates are urged to submit abstracts for both oral and poster presentations at the same time as they register for the meeting and book their Conference Package. **Abstracts cannot be accepted until registration fees of the presenting author are received.** Each registered delegate may submit one abstract for oral presentation and one for a poster (invited keynote speakers may also submit an abstract for a regular oral presentation). All abstracts will be subject to review by the organizing committee and additional referees as necessary. While we will endeavour to schedule presentations in the format (oral or poster) and topical session indicated by the author(s), it may be necessary to shift some abstracts to an alternate format to avoid overfilling sessions. Oral presentations will only be accepted using Microsoft Office PowerPoint for PC (2003 or 2007 versions). We encourage all delegates to test their presentation on a PC (in particular if the original presentation was made on a MAC computer) before handing over their presentation to the conference organizers. Please store your presentation on a USB key, CD or DVD. Please prepare your posters to fit on boards 4 feet in height (120 cm) by 6 feet in width (180cm). **Format:** Abstracts should be prepared and submitted as MS Word documents (Word 2003 compatible). All abstracts will be limited to one (1) standard 8.5"x11" letter-size page with 1" margins (left, right, top and bottom). For all text, including title, author names and author affiliations, please use 12 point Times New Roman font with single line spacing, left justified. Use UPPER CASE characters for the full title text and for author surnames; formal species names in the title should be *ITALICIZED*. Leave one blank line between author affiliations and the main body of text, and between each paragraph (do not indent first lines). **Abstract Submission:** Abstracts should be carefully prepared and proof-read by the author(s) prior to being sent as an e-mail attachment (in MS Word format) to: **Lorna O'Brien** ([lornao@rom.on.ca](mailto:lornao@rom.on.ca)) or **Martin Smith** ([martins@rom.on.ca](mailto:martins@rom.on.ca)) Please indicate "ICCE Abstract" in the e-mail subject header. **Example of required abstract format:**

### C. D. WALCOTT AND THE BURGESS SHALE – OPENING A WINDOW ON THE WORLD OF *MARRELLA SPLENDENS*

Abelard T. THROME<sup>1</sup>, O. L. D. WHIPSNERD<sup>2</sup>, and Pasu ZITTS<sup>3</sup>

<sup>1</sup>Institute for Advanced Redundancy, 15 Impossible Way, Toronto, ON, Canada M3Z 2Q6

<sup>2</sup>University of East West, North South Banshee, TX, USA 77414

<sup>3</sup>Department of Divisions, Flog University, Box 20000, S-100 00, Stockholm, Sweden

In 1909, at the spry young age of 69 years, Charles Doolittle Walcott embarked upon yet another foray into the mountains of British Columbia in pursuit of new Cambrian fossils.

Accompanied by family, pack horses, a retinue of assistants and an enormous landscape camera, Walcott was about to make the discovery of an already accomplished lifetime!

Etc., etc., etc. ....



## Special Volume

Conference proceedings will be published as a volume in *Palaeontographica Canadiana*, Canada's national peer-reviewed paleontological monograph series. Papers are encouraged on any topic relevant to the theme of the conference, including systematic works. Please bring submission-ready manuscripts TO the conference itself on a CD or DVD. This will expedite the reviewing, editing and printing process and ensure a publication within months. Final deadline for submission of manuscripts is September 15-2009. In preparing your manuscript please follow the guidelines from "Journal of Paleontology" including for figures and tables. Maximum length for one manuscript will be 30 published pages. Publication in this special volume will be free of charge for the authors, except for color plates. For authors' instructions, please contact Paul Johnston or Kimberley Johnston: [editors@paleos.ca](mailto:editors@paleos.ca)

## Travel Information

The information provided below can also be accessed here: <http://www.banffcentre.ca/conferences/visitor/location.asp>

### Directions to "The Banff Centre"

Banff is well situated just inside the gates to Banff National Park and is an easy drive from both downtown Calgary and Calgary International Airport. Highway #1 (Trans-Canada) is well signed and offers a beautiful trip through prairies, foothills, and the Rocky Mountain main ranges. The following directions outline the trip from Calgary and from Banff townsite to "The Banff Centre."

- Shuttle and Bus information from Calgary International Airport:

**Banff Airporter** is the official airport shuttle provider of The Banff Centre. Multiple daily transfers run between Calgary International Airport and The Banff Centre for \$51.43 (CAD) one-way / \$95.24



Trans-Canada Highway (#1) from Calgary to Banff. *Photo JB Caron*



(CAD) return. GST (5%) is added to all fares. Reservations are necessary; please call 1-888-449-2901 in North America, use the booking application below, or visit their website to confirm times and rates. <http://www.banffairporter.com/scheduled.php>

For **Brewster coaches**, departures leave daily from Calgary International Airport to Banff hotels, and return daily from Banff to the airport. Fare is \$50 (CAD) one-way. Please contact Brewster directly, to confirm times and prices - Brewster Transportation 1-800-760-6934, 403-762-6700 or visit Brewster, <http://www.brewster.ca/>

- Calgary International Airport to Banff by car

This is well-signed and the trip from the Calgary International Airport to Banff takes approximately 1.5 hours.

Depart airport via Barlow Trail (head towards Calgary City Centre).

Take 16th Avenue West exit and turn right onto 16th Ave. W.

Remain on 16th Ave. W. through Calgary - it becomes the Trans-Canada Highway #1. Continue to head west on the Trans-Canada Highway # 1 and eventually this will take you through the park gates to the exit for the town of Banff.

- Banff Townsite to The Banff Centre

Enter Banff from the East exit (**EXIT 1-on map below**) off of The Trans-Canada Highway.

Take Banff Ave to Moose Street (1st lights).

Turn left onto Moose St. and continue to end of street.

Turn right on St. Julien Road and follow it up to The Banff Centre.

Enter Banff from the West exit (**EXIT 2-on map below**) off of The Trans-Canada Highway.

Immediately after the railway tracks, turn left on Railway Ave and then follow the road as it turns right & changes into Elk Ave. Follow Elk to Banff Ave. & turn left on Banff Ave. for one block.

Turn right onto Moose St. and continue to end of street.

Turn right on St. Julien Road and follow it up to The Banff Centre.

Map of Banff Townsite : [http://www.pc.gc.ca/pn-np/ab/banff/visit/visit1aa\\_E.asp](http://www.pc.gc.ca/pn-np/ab/banff/visit/visit1aa_E.asp)



Adapted from Parks Canada:  
[http://www.pc.gc.ca/pn-np/ab/banff/visit/visit1aa\\_E.asp](http://www.pc.gc.ca/pn-np/ab/banff/visit/visit1aa_E.asp)

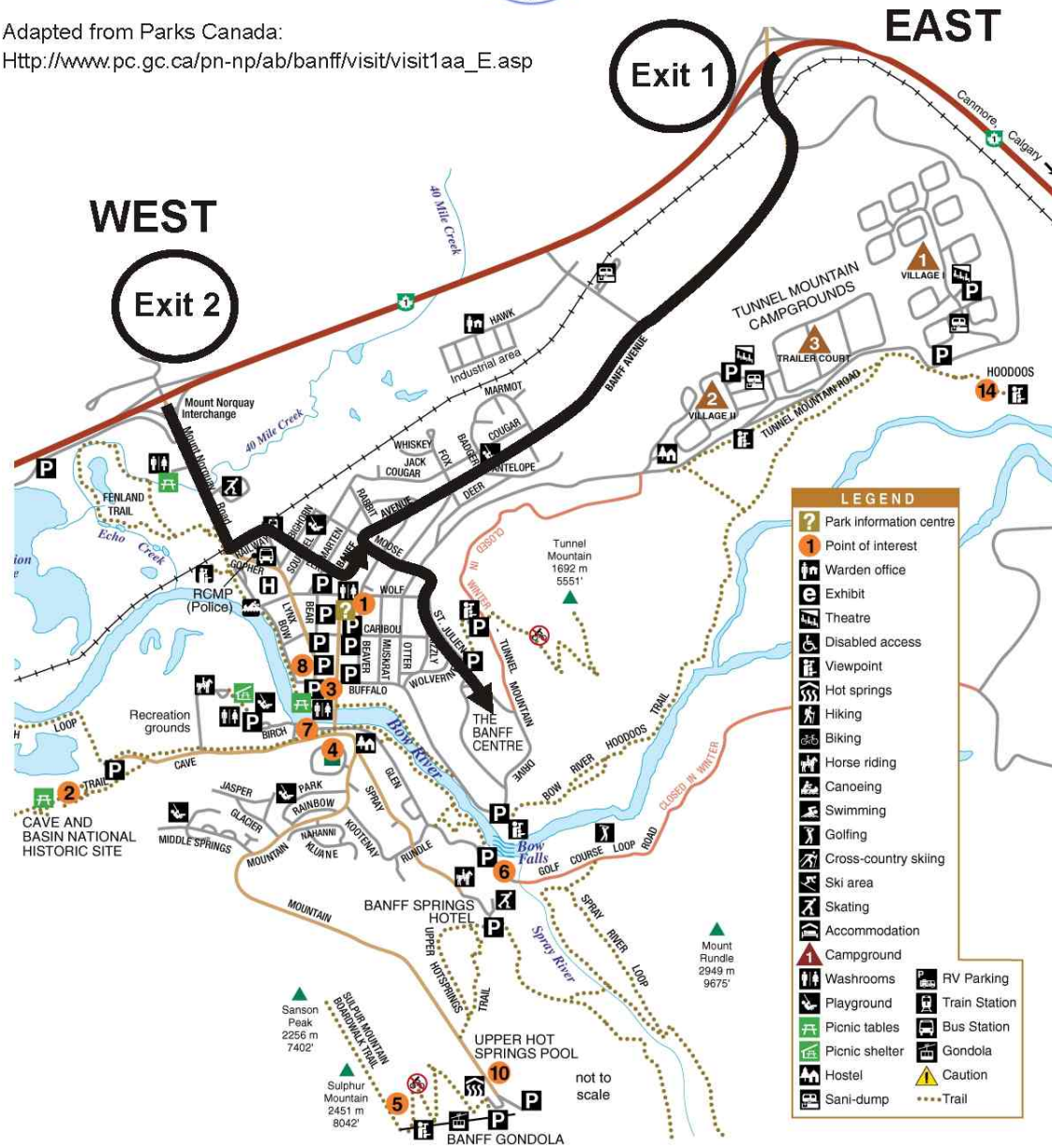



## Banff Centre Campus

Long-term parking is available in two locations: the underground parkade on the north side of campus and the visitor parking lot on the south end of campus. Short term parking is available throughout campus, as noted on the map. Check-in is at the Professional Development Centre. Campus directories are located at the two entrances.

view map below [http://www.banffcentre.ca/about/location/images/getting\\_around\\_map\\_900.jpg](http://www.banffcentre.ca/about/location/images/getting_around_map_900.jpg)

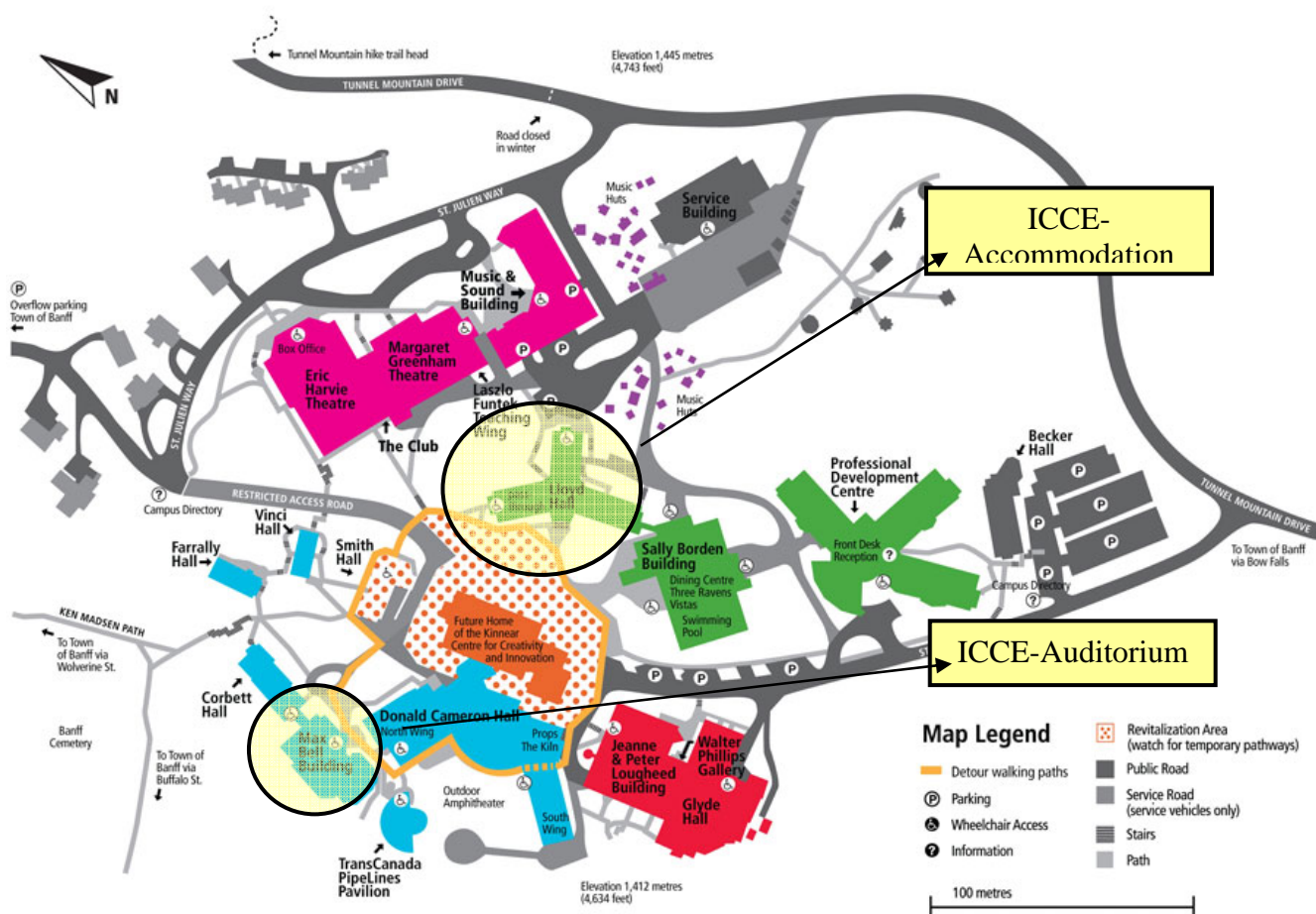



## Travel Insurance

All delegates should have proper travel and health insurance to attend this meeting and the field trips. Please check with your insurance provider that you are covered in case of emergency evacuation, hospitalization and repatriation.

## Contact Info

For general inquiries: Dr. **Jean-Bernard Caron**. Associate Curator of Invertebrate Paleontology, Department of Natural History, Royal Ontario Museum, 100 Queen's Park, Toronto, Ontario, M5S 2C6 CANADA, Tel: 416-586-5593 #1. Fax: 416-586-5882  
[jcaron@rom.on.ca](mailto:jcaron@rom.on.ca)

For Abstract submission: **Lorna O'Brien** ([lornao@rom.on.ca](mailto:lornao@rom.on.ca)) or **Martin Smith** ([martins@rom.on.ca](mailto:martins@rom.on.ca))

For conference proceedings: **Paul Johnston** or **Kimberley Johnston**: [editors@paleos.ca](mailto:editors@paleos.ca)

## International Scientific and Organizing Committee

### Co-Chairs:

Dr. Jean Bernard Caron (Royal Ontario Museum, Toronto), [jcaron@rom.on.ca](mailto:jcaron@rom.on.ca)

Dr. Doug Erwin (Smithsonian Institution, Washington), [ERWIND@si.edu](mailto:ERWIND@si.edu)

David Rudkin (Royal Ontario Museum, Toronto), [davidru@rom.on.ca](mailto:davidru@rom.on.ca)

### Members:

Dr. Stephen Dornbos (University of Wisconsin-Milwaukee), [sdornbos@uwm.edu](mailto:sdornbos@uwm.edu)

Dr. Sarah Gabbott (University of Leicester), [sg21@le.ac.uk](mailto:sg21@le.ac.uk)

Dr. Robert Gaines (Pomona College), [robert.gaines@pomona.edu](mailto:robert.gaines@pomona.edu)

Dr. Charles Henderson (University of Calgary), [cmhender@ucalgary.ca](mailto:cmhender@ucalgary.ca)

Dr. Paul Johnston (Mount Royal College, Calgary), [pajohnston@mtroyal.ca](mailto:pajohnston@mtroyal.ca)

Kimberley Johnston (Palaeontographica Canadiana), [kimberley@paleos.ca](mailto:kimberley@paleos.ca)

Lorna O'Brien (Royal Ontario Museum, Toronto), [lornao@rom.on.ca](mailto:lornao@rom.on.ca)

Dr. George Pemberton (University of Alberta), [george.pemberton@ualberta.ca](mailto:george.pemberton@ualberta.ca)

Martin Smith (Royal Ontario Museum, Toronto), [martins@rom.on.ca](mailto:martins@rom.on.ca)

Dr. Jean Vannier (Université Claude Bernard Lyon 1), [jean.vannier@univ-lyon1.fr](mailto:jean.vannier@univ-lyon1.fr)

Dr. Xingliang Zhang (Department of Geology, Northwest University, Xian), [xlzhang@pub.xaonline.com](mailto:xlzhang@pub.xaonline.com)

Dr. Maoyan Zhu (Nanjing Institute of Geology and Palaeontology, Chinese Academy of Sciences), [myzhu@nigpas.ac.cn](mailto:myzhu@nigpas.ac.cn)



## Sponsors

### Financially Assisted by:

The International Burgess Shale  
Collection and Research Consortium



The Polk Family Charitable Fund

Paleontology Division of the  
Geological Association of Canada

### The commemoration events are under the patronage of:



COMMISSION CANADIENNE POUR L'UNESCO  
CANADIAN COMMISSION FOR UNESCO

[www.unesco.ca](http://www.unesco.ca)

International Palaeontological Association

### Web assistance:

